

Downflow Economizer Kit for (R,P,Q) 7TQ- 072 / 090/ 120 Series

INSTALLATION INSTRUCTIONS

This product is certified to meet California Title 24, Part 6 Low Leak and FDD requirements

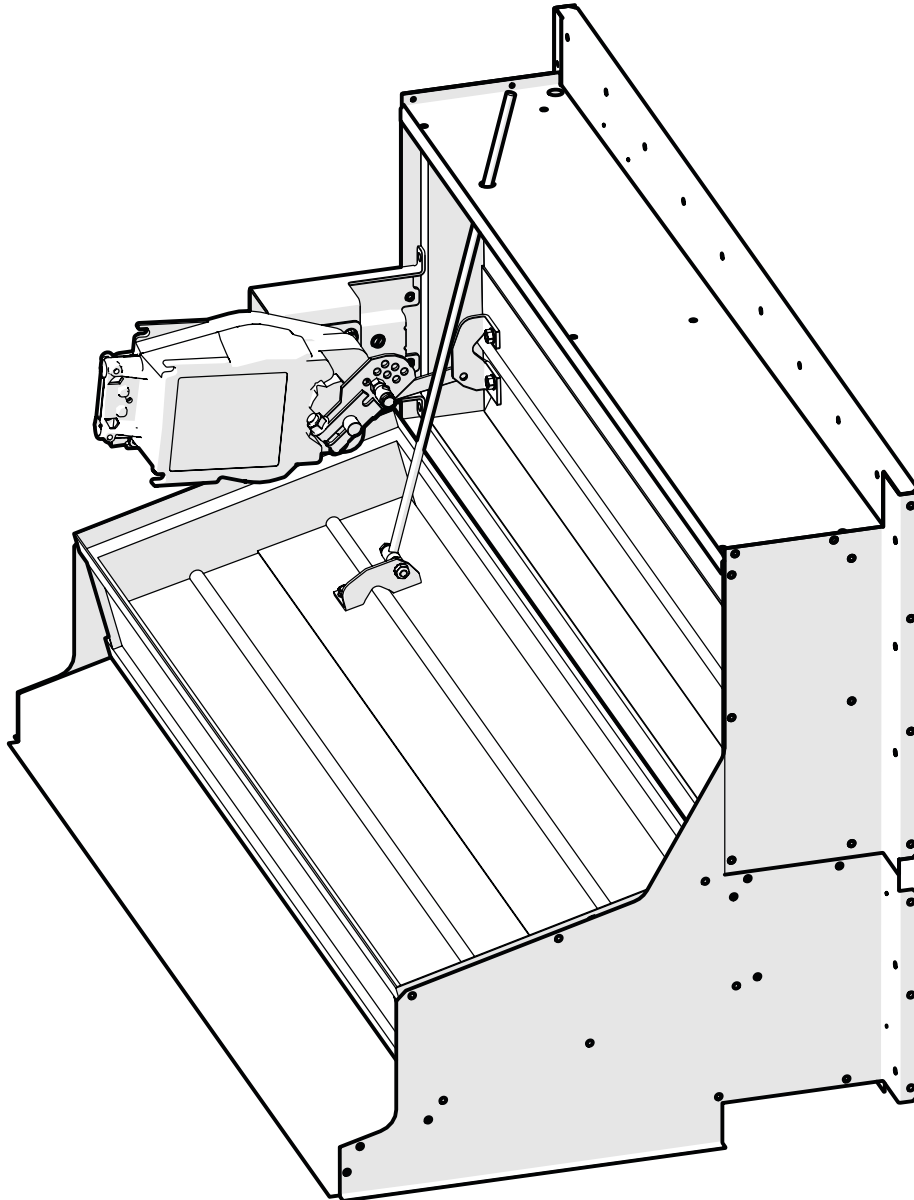

DO NOT DESTROY, PLEASE READ CAREFULLY & KEEP IN A SAFE PLACE FOR FUTURE REFERENCE.

IMPORTANT SAFETY INFORMATION

Please read all instructions before servicing this equipment. Pay attention to all safety warnings and any other special notes. Safety markings are used frequently throughout these instructions to designate a degree or level of seriousness and should not be ignored. **WARNING** indicates a potentially hazardous situation that if not avoided, could result in personal injury or death. **CAUTION** indicates a potentially hazardous situation that if not avoided, may result in minor or moderate injury or property damage.

WARNING:

ELECTRICAL SHOCK, FIRE OR EXPLOSION HAZARD

Failure to follow safety warnings exactly could result in serious injury or property damage.

Improper servicing could result in dangerous operation, serious injury, death or property damage.

- Before servicing, disconnect all electrical power to the unit.
- Verify proper operation after servicing.

WARNING:

The information listed in these instructions must be followed during the installation, service, and operation of this unit. Unqualified individuals should not attempt to interpret these instructions or install this equipment. Failure to follow safety recommendations could result in possible damage to the equipment, serious personal injury or death.

CAUTION:

To avoid personal injury or property damage, make sure the motor leads do not come into contact with any metal components of the unit.

- Before beginning the installation, verify the unit model number. The unit model number is printed on the data label.
- Follow all precautions in the literature, on tags, and labels provided with the equipment. Read and thoroughly understand the instructions provided with the equipment prior to performing the installation and operational checkout of the equipment.

- Use caution when handling this equipment or removing components. Personal injury can occur from sharp metal edges present in all sheet metal constructed equipment.
- Before installation, verify that the economizer ordered is the appropriate size for the unit.
- Inspect packaging for damage, or forced entry.
- Verify that all parts requested are accounted for, See Table 1.

| P/N | DESCRIPTION | QTY |
|---------|---|-----|
| 101607 | Perm Alum Filter 16 X 20 X 1 | 2 |
| 101608 | Perm Alum Filter 20 X 20 X 1 | 2 |
| 626621 | Control, Jade Logic MOD, HW #W7220A1000/U | 1 |
| 626623 | Sensor, Dry Bulb (MAS), HW # C7250A1001/U | 1 |
| 626622 | Sensor, Enthalpy, HW # C7400S1000/U | 1 |
| 1005892 | Economizer Bottom Front | 1 |
| 1005894 | Economizer Right Side | 1 |
| 1005895 | Economizer Center Blockoff | 1 |
| 1005896 | Economizer Top | 1 |
| 1005905 | Intake Hood Right Side | 1 |
| 1005906 | Intake Hood Left Side | 1 |
| 1005907 | Intake Hood Top | 1 |
| 1005908 | Intake Filter Support Bottom | 1 |
| 1005909 | Intake Filter Slide Right | 1 |
| 1005910 | Intake Filter Slide Left | 1 |
| 1005911 | Intake Hood Filter Access | 1 |
| 1005912 | Exhaust Hood Right Side | 1 |
| 1012045 | Outside Air Hood Baffle | 1 |
| 1005913 | Exhaust Hood Left Side | 1 |
| 1005914 | Exhaust Hood Top | 1 |
| 1005918 | Economizer Bottom Rear | 1 |
| 1006475 | Outside Air Damper, Modulating Actuator | 1 |
| 1006476 | Return Air Damper | 1 |
| 1005893 | Economizer Left Side | 1 |
| 1006485 | Plug ASM, 15 Pin, Economizer | 1 |
| 38157 | Bushing HEYCO SR-6W-1 (1184) | 2 |
| 1006265 | Econ RA Enthalpy Sensor Brkt. | 1 |
| 1006266 | Econ SA Enthalpy Sensor Brkt. | 1 |
| 1013140 | LC Cab B Barometric Damper Asm. | 1 |
| 1013141 | LC Cab B Barometric Damper Rt Side Mount | 1 |
| 1013142 | LC Cab B Barometric Damper Lt Side Mount | 1 |

Table 1. Material List

1. Verify all power has been shut off to the unit.
2. Remove and discard covers "A" and "B" to expose back panel area that needs removed. See Figure 1.
NOTE: Retain hardware, this will be to be used for mounting economizer.
3. Cut out back panel to accommodate economizer installation. **NOTE:** Panel removal can be accomplished by using a dull blade. Care should be exercised to not cut into the sheet metal edges of the opening while cutting the foam insulation. See Figure 2.
4. After panel is removed deburr and clean surfaces prior to applying adhesive sealant.
5. Apply a bead of adhesive sealant around the perimeter of

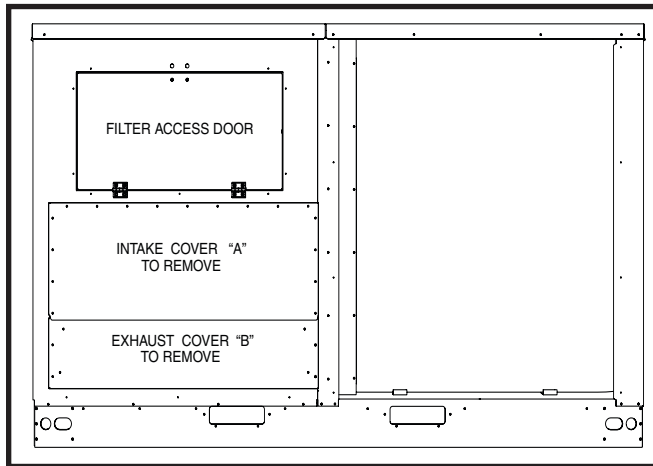

Figure 1. Covers To Remove

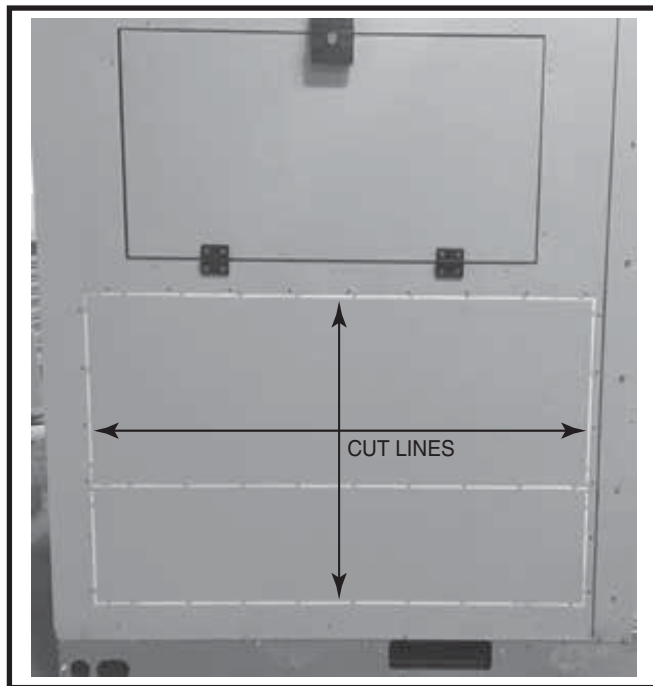

Figure 2. Area to be Cut Out

6. Locate the economizer into position so the mounting holes align with the existing cover mounting holes.
7. Fasten the economizer using screws retained from removing covers "A" & "B".

8. Cut shipment retaining strap on controller packaging to free controller and mixed air sensor from economizer assembly shipping position.
9. Controller mounts on back side of filter access door in pre-existing mounting holes. Attach cable ties and mount using existing holes. See Figure 3.
10. Locate single point wiring harness pigtail inside filter access area and remove jumper plug to accept economizer control connection. Plug connectors together.
NOTE: Secure jumper to wiring harness for future use if required. **Do not discard.**
11. Mount mixed air sensor (C7250A) to filter rack in existing holes See Figure 4.

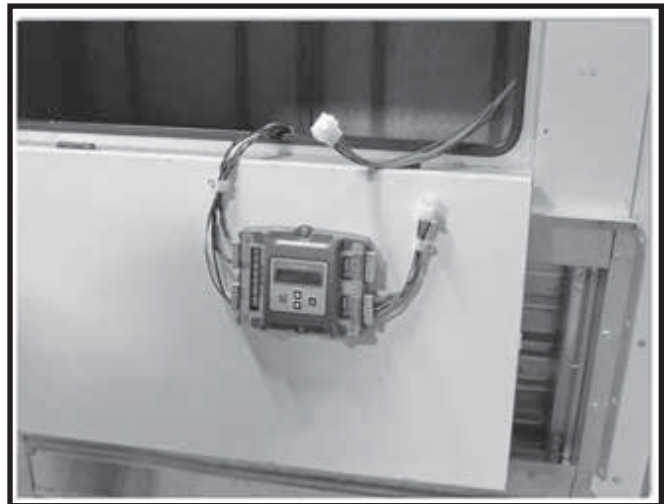

Figure 3. Unit control mounted on back side of filter access door

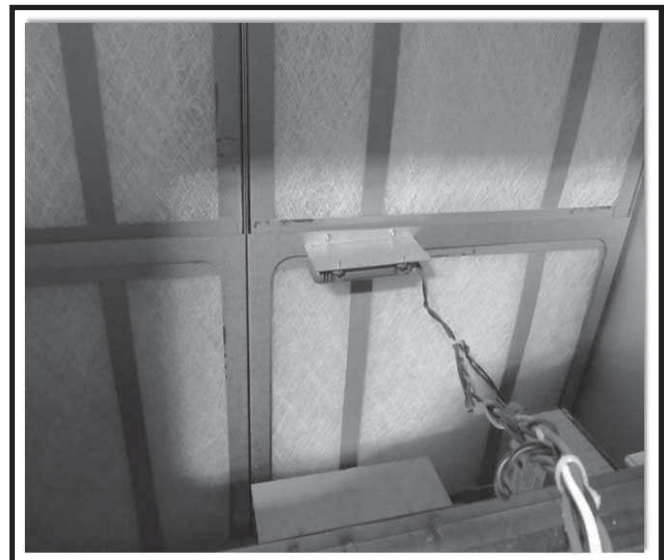

Figure 4. Mixed air sensor (C7250A) mounted on unit filter rack

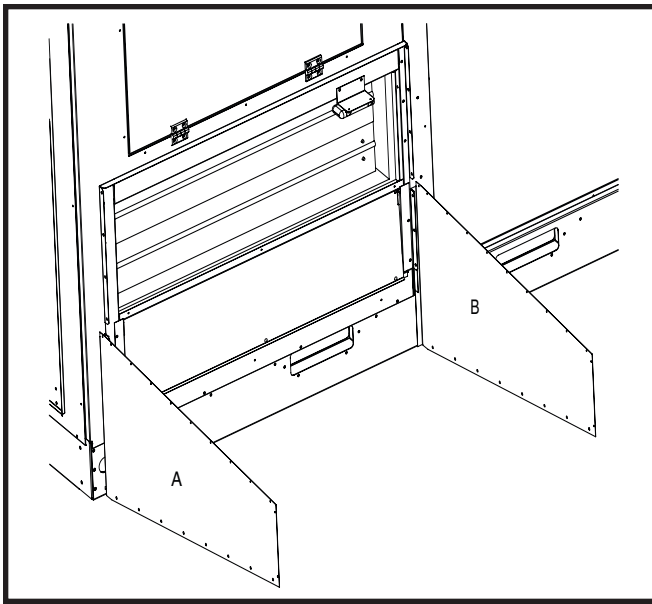

Figure 5. Exhaust hood sides installed

12. Install the barometric damper as follows:
- Install damper ride side mount.
 - Slide the damper left side mount onto the damper and hold together as an assembly.
 - Insert the damper hinge rod into the right side mount.
 - Hold the left side mount and install the left side mount.
 - Verify smooth operation of the damper.

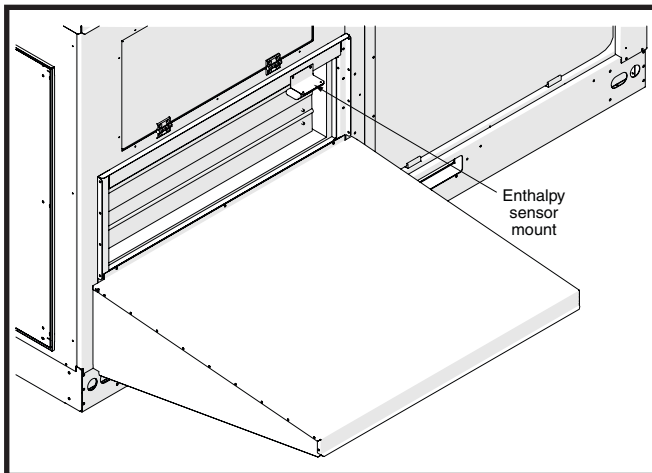

Figure 6. Exhaust Hood Top Installed

- Install exhaust hood sides. "A" then "B". See Figure 5.
- Install exhaust hood top. See Figure 6.
- Apply a bead of adhesive sealant to mounting surface of intake hood sides prior to installing.
- Install intake hood sides similar to exhaust hood sides.
- Apply a bead of adhesive sealant to mounting surfaces prior to installing filter slide assembly.
- Install filter slide assembly and secure to intake hood sides. See Figure 7.
- Apply a bead of adhesive sealant to mounting surface of baffle prior to attaching to intake sides. Attach with supplied screws. See Figure 7.
- Apply a bead of adhesive sealant to mounting surfaces of the intake sides before installing hood top. See Figure 8. Install filters & filter access cover to hood sides.
- Review and follow controller operation instruction provided for correct unit start up and setting the configuration.

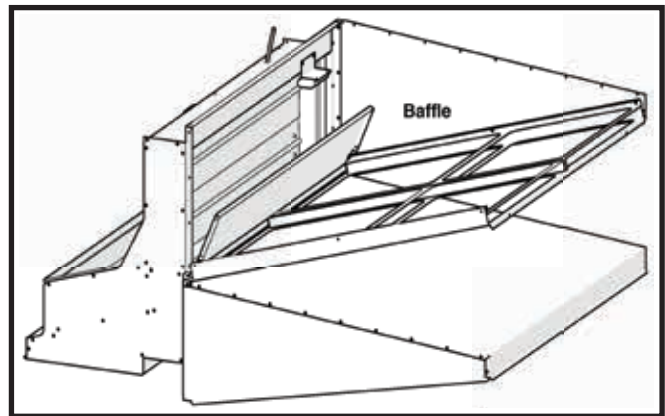

Figure 7. Assembly shown with side removed to show baffle location

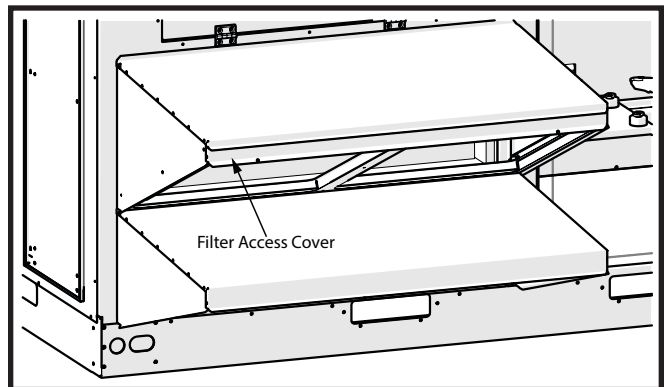

Figure 8. Intake top and filter access cover installed

